

Elevation to the Clyde

Scale 1 : 200

Rear of Pier

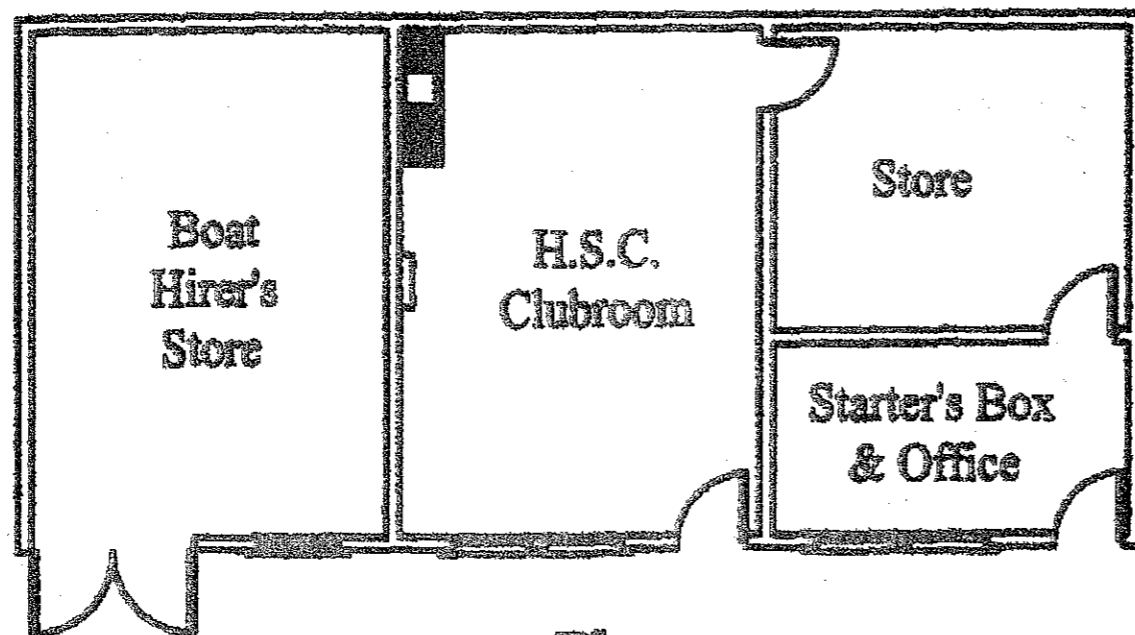

Plan

Scale 1 : 200

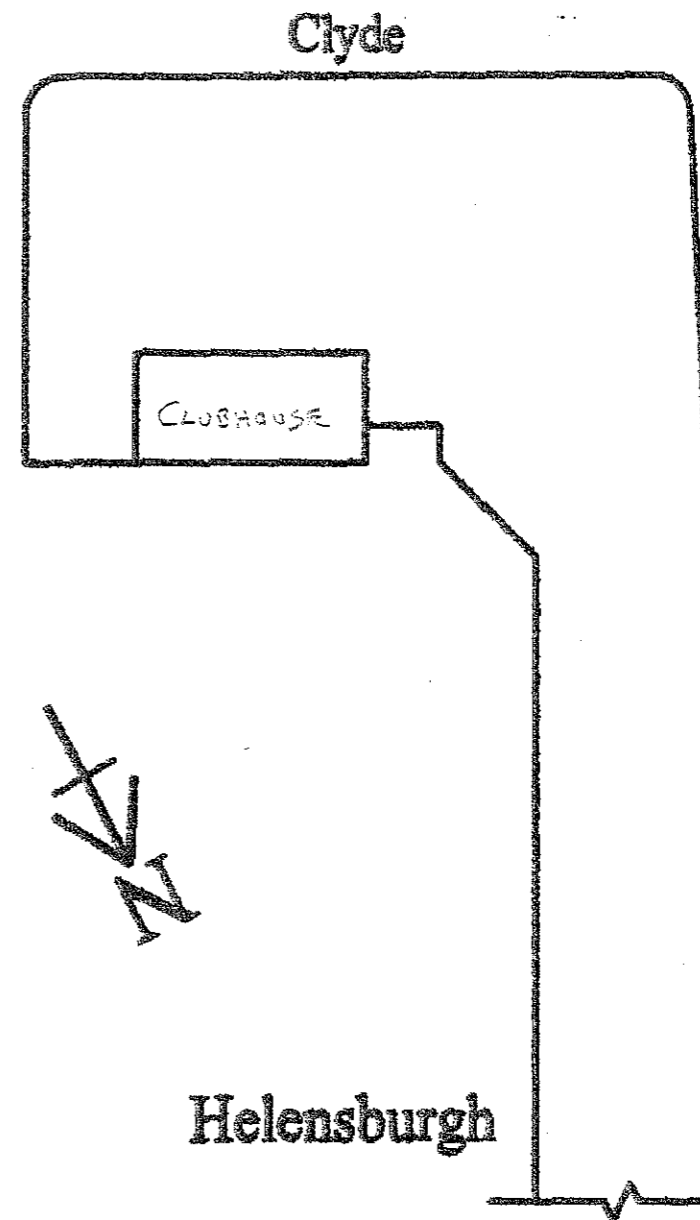

Helensburgh Pier

Scale 1 : 100

The Pier Head Clubhouse 1951 to 1959, from 1960 to 1967 when present clubhouse was built the brick shelter at the south end of the dinghy park was the centre of all club activities.

This representation of the above drawing is not to scale.

A.S.Douglas